



# 12 VG 33

## BATTERY SPECIFICATIONS

### GEL 12V33Ah

The Valen GEL – the solution for all your heavy cyclic applications! Valen Gel is a rechargeable, deep cycle, Valve Regulated Lead Acid (VRLA) battery. This high-quality Gel battery has met and exceeded all market expectations over the years, and today continues to prove its excellence by its ability to resist deep discharges and recovering after heavy draining.

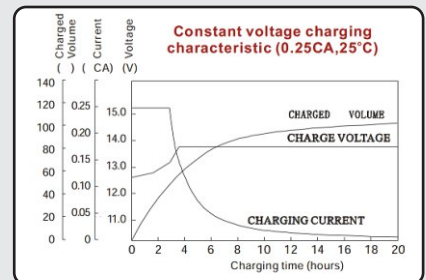
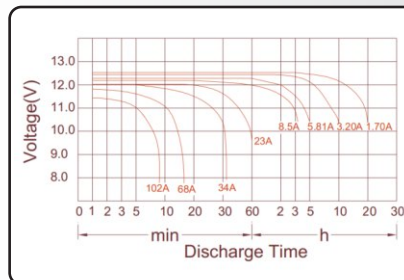
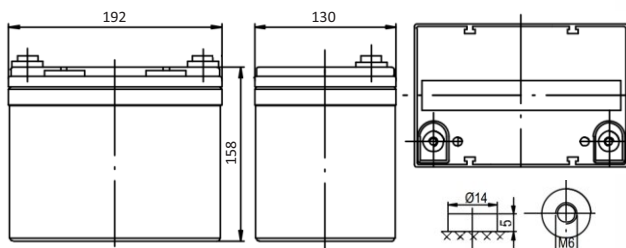

### SPECIFICATIONS

|                               |   |
|-------------------------------|---|
| <b>Voltage</b>                | 12 Volt nominal   |
| <b>Number of cells</b>        | 6   |
| <b>Design life</b>            | 10 years  |
| <b>Nominal Capacity 25°C</b>  |   |
| 20Hr rate (10.5V)             | 31Ah  |
| 10Hr rate (10.5V)             | 27.9Ah  |
| 5Hr rate (10.5V)              | 24Ah  |
| <b>Dimensions</b>             | 192(L)x130(W)x158(H)  |
| <b>Weight</b>                 | 11Kg  |
| <b>Plates</b>                 | Heavy duty  |
| <b>Terminal</b>               | Insert - M6   |
| <b>Container/cover</b>        | ABS   |
| <b>Charge voltage</b>         | Cycle: Maximum charge current - 7.8A<br>Voltage 2.35 vpc at 25°C<br>Standby Voltage: 2.25 vpc at 25°C |
| <b>Internal Resistance</b>    | 7.3mΩ 25°C - Fully charged Battery  |
| <b>Electrolyte</b>            | Thixotropic Gel - Sulphuric acid  |
| <b>Vent</b>                   | Self-sealing – 2psi operation   |
| <b>Operating temperature:</b> | -25°C to +55°C  |

(However it is recommended that the batteries be operated in the temperature range of 20 to 30°C to obtain full life and optimum performance.)

#### Discharge Constant Current (Amperes at 25°C)

| End Point<br>Volts/Cell | 15min | 30min | 1h   | 3h   | 5h   | 10h  | 20h  | 100h |
|-------------------------|-------|-------|------|------|------|------|------|------|
| 1.75V                   | 46.9  | 27.9  | 16.8 | 7.35 | 4.80 | 2.79 | 1.55 | 0.34 |

#### Discharge Constant Power (Watts at 25°C)

| End Point<br>Volts/Cell | 15min | 30min | 1h   | 3h   | 5h   | 10h  | 20h  |
|-------------------------|-------|-------|------|------|------|------|------|
| 1.75V                   | 89.1  | 53    | 32.2 | 14.2 | 9.36 | 5.47 | 3.07 |

